

EXPOSED THERMOSTATIC FAUCET

K-73110T

ALSO K-73164T

Features

- Brass construction
- Durable KOHLER finishes resist corrosion and tarnishing
- Directionally adjustable, laminar-flow aerator
- Spout reach 127 mm
- Adjustable inlet fittings with 15mm tolerance
- Precise thermostatic control for added safety
- Includes Rain Duet push button, 3 function handshower

Codes/Standards Applicable

- GB 18145-2014 • TIS 2066-2552
- GB/T 23447-2009 • QB 2806-2006
- EN 1111-1998

Installation Notes

Install this product according to the installation guide.



Specified Model

Model	Description	Color/Finished		
K-73110T-7	Composed Exposed Bath Shower Thermostatic Faucet	<input type="checkbox"/> Polished Chrome (CP)	<input type="checkbox"/> French Gold (AF)	<input type="checkbox"/> Titanium (TT)
K-73164T-7	Composed Exposed Shower Only Thermostatic Faucet	<input type="checkbox"/> Polished Chrome (CP)	<input type="checkbox"/> French Gold (AF)	<input type="checkbox"/> Titanium (TT)

For a full range of color finishes in your market please contact your local Kohler representative.

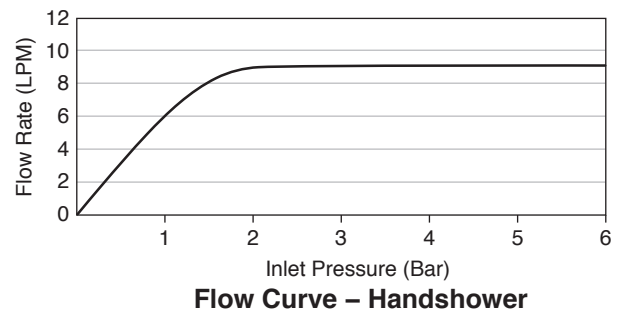
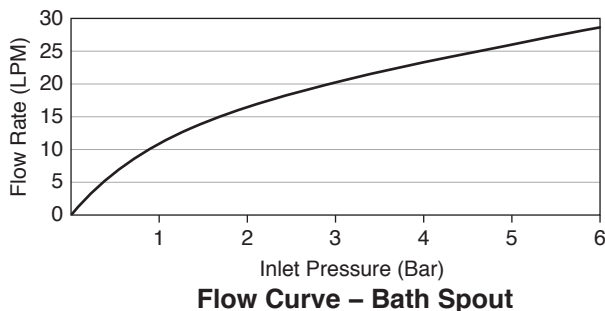

Note: Flow rates are approximate. (1 gallon = 3.785 liters, 1 bar = 14.5 psi)

Dimensions are approximate.
Unit: mm

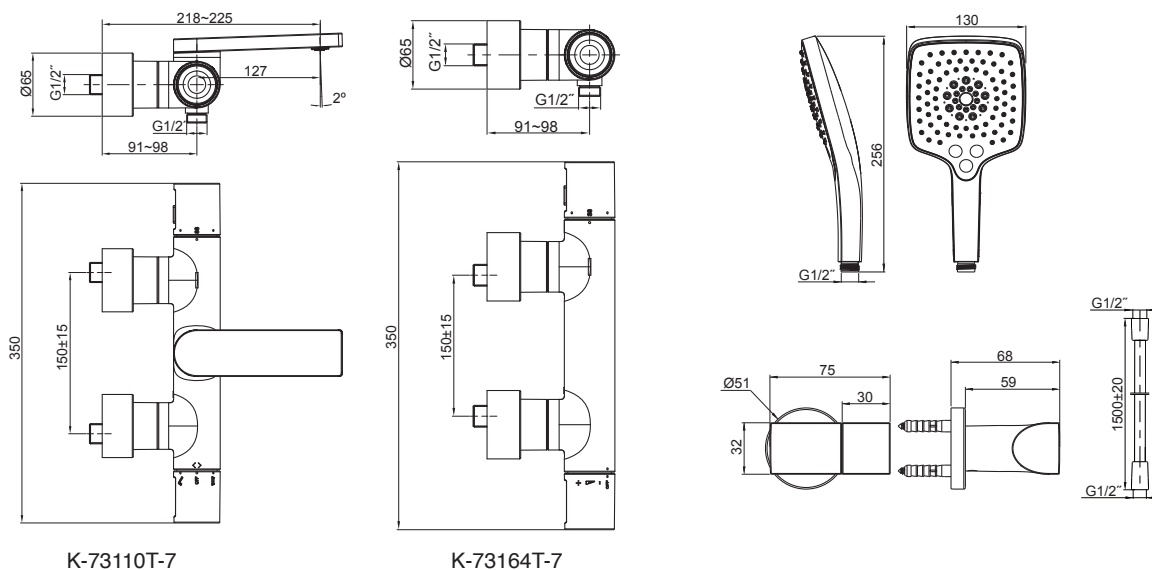

Product Diagram